

Slash Pond Nature Trail

Welcome to the
Broad Haven Slash Pond Nature Trail.
Simply follow the red numbered discs, these
correspond to the questions in your nature
trail quiz leaflet. Good luck and have fun
discovering some of the local wildlife.

Children must be accompanied by an adult
at all times.

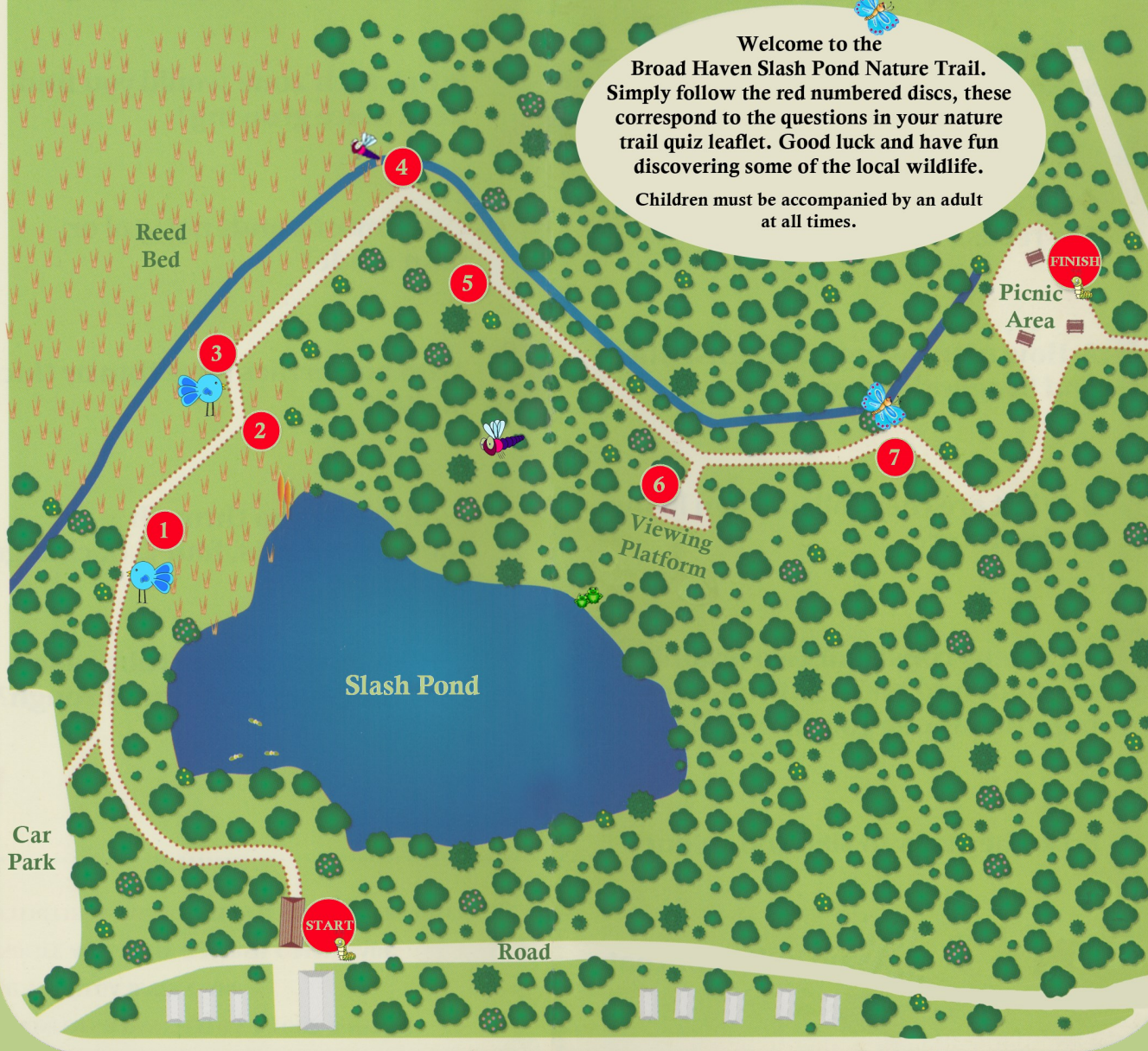

www.supporttheboardwalk.co.uk



SUPPORT THE BOARDWALK Nature Trail QUIZ



Fundraising has begun to re-open, refurbish & maintain The Slashpond Boardwalk & Nature Trail.

This beautiful, popular amenity will benefit from a group of enthusiastic volunteers taking good care of it!

Support The Boardwalk group will raise funds to enhance, preserve & widen its appeal.

YOUR DONATIONS are received with the greatest of thanks and can be posted to K.Markham c/o Support the Boardwalk, 65 Puffin Way, Broad Haven, SA62 3HP cheques should be made payable to 'Support The Boardwalk'.



Keep up to date with Support The Boardwalk Events on our Facebook page, attend the next meeting, or join in with the next Working party

www.facebook.com/supporttheboardwalk



How to use:

Go to the starting place shown as red circle Number 1 on the map at the back of this leaflet. The questions seen here relate to the numbers as shown on the map. Follow 1 to, 3 to 4 and so on, writing your answers below the questions. The answers are shown below but NO PEEKING until you have completed the nature trail! Good luck and have fun learning about the wildlife here at Slash Pond.

Children must be accompanied by an adult at all times.

1

- A. Trees around ponds provide a good home for many birds, as they attract an abundance of ----- as well as providing good shelter.



- B. Which bird is one of the first to sing in the 'dawn chorus'?

- C. Name the bird beginning with 'S' that swoops down onto smaller birds.

2

- A. Is 'Common Reed' a member of the grass family?

- B. Is it a tall or short plant?

- C. Another plant you may see here is Yellow ----- Iris.

3

- A. In which country do Reed Warblers live during winter?

- B. They eat mainly insects, with some ----- in autumn.

- C. Do they wrap their nests around the reeds?

4

- A. How many wings do Damselflies and Dragonflies have?



- B. What are they called when living underwater?

5

- A. Lichens consist of two organisms; a fungus and an ----- that function together as one complete being.

- B. Do they vary in size and colour?

- C. Lichens are a good indicator that ----- quality is good.

6

- A. Plants are one of the most important elements of a ----- pond environment.

- B. In which 'zone' would you find Reed Mace growing?

- C. Are most ponds natural or man-made?

7

- A. Do butterflies have thin or thick bodies?

- B. All species go through 'metamorphosis', four ----- of change.

- C. What is the hollow tube called that they suck nectar in through?



1. *Birds*: A = Insects, B = Blackbird, C = Sparrowhawk
2. *Plants*: A = Yes, B = Tall, C = Flag
3. *Reed Warbler*: A = Africa, B = Berries, C = Yes
4. *Dragonflies & Damselflies*: A = Four, B = Nymphs
5. *Lichens*: A = Alga, B = Yes, C = Air
6. *Pondlife*: A = Healthy, B = Marsh, C = Man-made
7. *Butterflies & Moths*: A = Thin, B = Stages, C = Proboscis

ANSWERS



Cronfa Amaethyddol Ewrop ar gyfer
Datblygu Gwledig: Ewrop yn Buddsoddi
mewn Ardaloedd Gwledig
The European Agricultural Fund for
Rural Development: Europe Investing in
Rural Areas



Llywodraeth Cymru
Welsh Government